

Assembly Instruction Montageanleitung

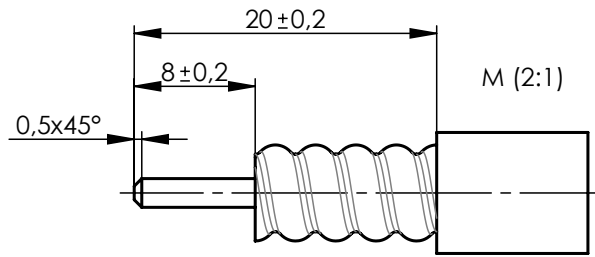

for cable stripping / zum Abisolieren
Recommended rotation tool
Empfohlenes Rotationswerkzeug
100033484

4.3-10

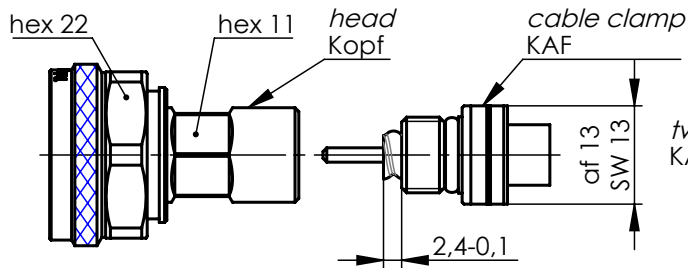

twist on cable clamp
KAF aufschrauben ①

② screw on head, please note lefthand thread
rec. torque 6 Nm
Kopf aufschrauben, Linksgewinde beachten
empf. Anzugsmoment 6 Nm

2.2-5

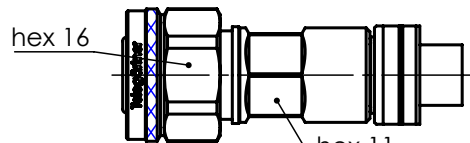

1.5-3.5

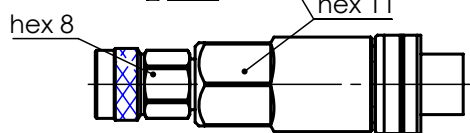

NEX10®

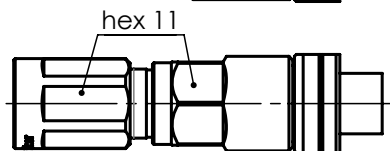

N(m)

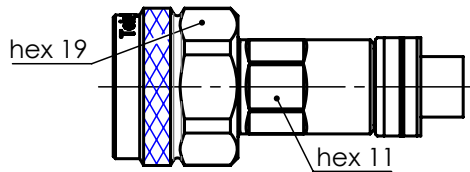

N(f)

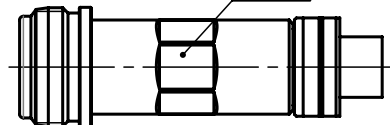

Änd./ rev. index	Änderungs-Nr. / revision code	Datum/ date	Name/ name	gez./ drawn	Datum/ date	Name/ name	Gewicht/ weight [g]	Oberfläche/ surface [mm²]	Volumen/ volume [mm³]	Werkstoff/ material	
				gepr./ appr.	30.11.2020	BJ	ca./approx.	ca./approx.	ca./approx.	Oberfläche/ finish	
					03.12.2020	VM					
Maßstab/ scale				Benennung/ title							
1:1 (2:1)				Assembly Instructions SIMFix G20 clamp							
a 500000000397				24.02.2022 BJ							
b 500000000878				19.01.2023 VM							
Allgemeintoleranz Maße/ general tol. for dimensions				Allgemeintoleranz Form und Lage / general tolerances for geometrical features				Untert./ doc. type		Materiainr./ material no.	
für Winkel mit Schenkel <1mm / for angle with side length <1mm				ASD				100033356		Ersatz für/ replaces	
P/N ISO 1101				Tol. x + Tol. y: Summe der Toleranz zweier anwendbarer Maße / Sum of the tolerance of two applicable dimensions				PDM Nr./ pdm no.		T00100E0013	
								Maße/ dimensions: mm		Original : DIN A4	
										Blatt/ sheet 1 von/ of 1	

